

CITY OF
NORTH BATTLEFORD
2023 TRAFFIC
VOLUME & SPEED REPORT

**CITY OF NORTH BATTLEFORD
2023 TRAFFIC VOLUME & SPEED
REPORT**

**CITY OF NORTH BATTLEFORD
CITY OPERATIONS**

January 2024

Disclaimer

The City of North Battleford compiles the following information and believes it to be accurate; however, the City will not be responsible for errors or omissions in the analysis and use of this information.

TABLE OF CONTENTS

List of Illustrations	iii
Introduction	1
Traffic Counting Procedures.....	1
Calculation of Average Daily Traffic	1
Traffic Flow Counting Stations A.D.T.	2
Conclusion	18

LIST OF ILLUSTRATIONS

Tables

Table 1: 2023 Daily Traffic Counting Stations (averaged over a minimum of one week).....	2 - 4
--	-------

Figures

Figure 1: Grid for 2023 Traffic Volume Count Locations.....	5
Figure 2: Page 1 of 2023 Traffic Volume Count Locations	6
Figure 3: Page 2 of 2023 Traffic Volume Count Locations	7
Figure 4: Page 3 of 2023 Traffic Volume Count Locations	8
Figure 5: Page 4 of 2023 Traffic Volume Count Locations	9
Figure 6: Page 1 of 2023 85 Percentile Speed Locations	10
Figure 7: Page 2 of 2023 85 Percentile Speed Locations	11
Figure 8: Page 3 of 2023 85 Percentile Speed Locations	12
Figure 9: Page 4 of 2023 85 Percentile Speed Locations	13
Figure 10: Page 1 of 2023 Speed Limit Locations	14
Figure 11: Page 2 of 2023 Speed Limit Locations	15
Figure 12: Page 3 of 2023 Speed Limit Locations	16
Figure 13: Page 4 of 2023 Speed Limit Locations	17

INTRODUCTION

The Operations Department of the City of North Battleford has been counting, compiling, and analyzing traffic movements within and around the city of North Battleford for many years. The data collected is used by the City staff for traffic planning, control design, speed enforcement, and compiling an Annual Traffic Volume Report.

This is the 20th Annual Traffic Volume Report that summarizes traffic volumes within the city of North Battleford. No count was made from the years 2019 until 2023 due to lack of resources, which the city now has available. This report is not intended to be an in-depth study of traffic movement, but rather a collection of traffic volumes and speeds intended for personal interpretation and analysis.

TRAFFIC COUNTING PROCEDURES

The City has purchased Houston Radar Armadillo counters allowing for counts to be conducted year-round. Each count station is up for a minimum of one week, recording data 24 hours a day. A total of 101 Count stations have been identified in this report, however not all have been counted and stations may be added or removed as required. In addition to counts, size, direction of travel, location, and speed of vehicles are also recorded.

CALCULATION OF AVERAGE DAILY TRAFFIC

Traffic volume information is always expressed in some unit of time. The most common time periods are hourly and daily. Traffic counts fluctuate depending on the time of year, roadway classification, roadway location, and the occurrence of special events. These fluctuations make direct comparison of short-term counts taken at different locations difficult. In order to provide comparable figures, an appropriate correction factor is applied to the Average Daily Traffic (A.D.T.) count. An A.D.T. is defined as the total traffic volume at a specific location during a given time period, divided by the number of days during that period. The correction factor that is applied to the A.D.T. is performed by the software used to manage the counters.

COUNTING STATIONS A.D.T. AND 85 PERCENTILE SPEED

Table 1 provides a complete listing of the 101 Count stations. Of those listed, 97 were observed in 2023.

Table 1: 2023 Daily Traffic Count Stations (averaged over a minimum of one week)

Count Station	Count	85 Percentile Speed	Posted Speed Limit
91st St.: 1500 Blk.	190	39 km/h	50 km/h
91st St.: 1800 Blk.	631	49 km/h	50 km/h
95th St.: 19th Ave. - Abbott Ave.	1083	52 km/h	50 km/h
95th St.: Territorial Dr. - Panton Ave.	1585	49 km/h	50 km/h
99th St.: 800 Blk	1039	45 km/h	50 km/h
100th St.: 1100 Blk.	8509	50 km/h	50 km/h
100th St.: 1500 Blk.	8687	52 km/h	50 km/h
100th St.: 1800 Blk.	10095	55 km/h	50 km/h
100th St.: North of 20th Ave.	9274	59 km/h	50 km/h
100th St.: South of Territorial Drive	9110	61 km/h	50 km/h
100th St.: 2500 Blk.	170	48 km/h	50 km/h
101st St.: 1100 Blk.	1911	35 km/h	50 km/h
101st St.: 1300 Blk.	1897	43 km/h	50 km/h
101st St.: 1500 Blk.	1519	44 km/h	30/50 km/h
101st St.: 1900 Blk.	1789	51 km/h	50 km/h
102nd St.: 1100 Blk	1809	41 km/h	50 km/h
103rd St.: 1100 Blk	928	41 km/h	50 km/h
110th St.: 700 Blk.	3672	54 km/h	50 km/h
110th St.: 1000 Blk.	3564	51 km/h	50 km/h
110th St.: 1100 Blk	2700	48 km/h	50 km/h
110th St.: 1400 Blk.	2462	45 km/h	50 km/h
110th St.: 1500 Blk.	3068	42 km/h	50 km/h
110th St.: North of Thompson Cr.	986	46 km/h	50 km/h
8th Ave.: 113th St. - 114th St.	701	48 km/h	50 km/h
8th Ave.: Airport Rd (East of Territorial Dr.)	436	46 km/h	30/50 km/h
11th Ave.: 101st - 102nd St.	4098	48 km/h	50 km/h
11th Ave.: 107th St. - 108th St.	3737	51 km/h	50 km/h
13th Ave.: 104th St. - 105th St.	1708	45 km/h	30/50 km/h
13th Ave.: 112th St. - 113th St.	1781	48 km/h	50 km/h
15th Ave.: 106th St. - 107th St.	2572	52 km/h	50 km/h
15th Ave.: 100th St. - 101st St.	2519	39 km/h	50 km/h
15th Ave.: 109th St. - 110th St.	1830	38 km/h	50 km/h
15th Ave.: 112th St. - Territorial Dr.	2761	53 km/h	50 km/h

Note: n/c is "not counted"

Table 1 (Continued)

Count Station	Count	85 Percentile Speed	Posted Speed Limit
15th Ave.: 91st St. - 92nd St.	427	49 km/h	50 km/h
15th Ave.: 99th St. - 100th St.	1449	44 km/h	50 km/h
19th Ave.: 93rd - 95th St.	1510	47 km/h	30/50 km/h
19th Ave.: 96th - 97th St.	2379	48 km/h	50 km/h
19th Ave.: 99th St. - 100th St.	2130	41 km/h	30/50 km/h
27th Ave.: 98th St. - Service Rd.	414	48 km/h	50 km/h
Abbott Ave.: Thomas Ave. - Panton Ave.	267	47 km/h	50 km/h
Abbott Ave.: Thomas Ave. - 95th St.	337	47 km/h	50 km/h
Battleford Rd: Pioneer Ave. - Railway Ave.	2967	40 km/h	50 km/h
Battleford Rd: Railway Ave. (Hwy 16B) - South Railway Ave.	3656	52 km/h	50 km/h
Battleford Rd: South Railway Ave. - Hwy #16	6304	55 km/h	50 km/h
Buhler Ave.: West Buhler Bay - Amos Dr.	300	48 km/h	50 km/h
Canola Ave.: Shorthorn St. - Aberdeen St.	98	51 km/h	50 km/h
Carlton Trail: Heritage Way - CU Plex	715	58 km/h	50 km/h
Carlton Trail: Past CUP to Exhibition Dr.	649	57 km/h	50 km/h
Carlton Trail: Territorial Dr. - Frontier Way	3261	43 km/h	50 km/h
Carlton Trail: Yellowsky Drive - Heritage Way	1557	61 km/h	50 km/h
Clark Dr.: Douglas Ave. - Gardiner Dr.	497	51 km/h	50 km/h
Clements Dr.: Territorial Dr. - Ross Cr.	2030	47 km/h	50 km/h
Clements Dr.: Hock Ave. - Bunce Cres.	1209	48 km/h	50 km/h
Clements Dr.: Maher Dr. - 27th Ave.	329	49 km/h	50 km/h
Douglas Ave.: Clark Dr./St. Laurent Dr. - Kramer Place	1710	52 km/h	50 km/h
Douglas Ave.: Scott Dr. - Dunning Cres.	1704	55 km/h	50 km/h
Douglas Ave.: MacDonald Dr. - Bennett Cres.	1445	56 km/h	50 km/h
Hereford Street: Marquis Ave. - Thatcher Ave.	172	58 km/h	50 km/h
Heritage Way: Carlton Trail to Gold Casino/Canadian Tire Access	1848	51 km/h	50 km/h
Heritage Way: North of Carlton Trail	865	41 km/h	50 km/h
Hwy #16: Simmental St. - Heritage Way	n/c	n/a	80 km/h
Hwy #16: West of Battleford Rd.- Hwy #4 E. of Overpass	9750	86 km/h	80 km/h
Hwy #16B: Werb St. - Territorial Dr.	7452	66 km/h	60 km/h
Hwy #16 East Service Rd: East of Territorial Drive (Mall Entrance)	3439	42 km/h	50 km/h
Hwy #4 North: Territorial Dr. - 25th Ave.	9921	66 km/h	50 km/h
Hwy #4 South: Territorial Dr. - Train bridge	n/c	n/a	50 km/h
Jersey Street: Thatcher Ave. - Fyfe Ave.	1063	56 km/h	50 km/h
Killdeer Dr.: Territorial Dr. - Meadow Lark Lane	1639	43 km/h	50 km/h

Table 1 (Continued)

Count station	Count	85 Percentile Speed	Posted Speed Limit
Peyak Trail: Territorial Drive	995	60 km/h	50 km/h
Peyak Trail: Griese St.	823	62 km/h	50 km/h
Pioneer Ave.: Werb St. - 114th St.	4330	56 km/h	50 km/h
Pioneer Ave.: 114th St. - Territorial Dr.	3201	49 km/h	50 km/h
Railway Ave.: 101st St. - 102nd St.	6436	58 km/h	50 km/h
Railway Ave.: 103rd St. - 104th St.	6148	60 km/h	50 km/h
Railway Ave.: 106th St. - Battleford Rd	6200	60 km/h	50 km/h
St. Laurent Dr.: West Mackenzie King Cres. - Thompson Cres.	1216	43 km/h	50 km/h
St. Laurent Dr.: Pearson Ave. - Douglas Ave.	1644	49 km/h	50 km/h
Sadlowski Dr.: Amos Dr. - Buhler Ave.	2031	44 km/h	50 km/h
Sandpiper Rd.: Finch Cres.	198	60 km/h	50 km/h
Scott Dr.: Clark Dr. - Martin Cres.	2031	47 km/h	50 km/h
Simmental St.: Hwy #16 - Thatcher Ave.	1419	47 km/h	50 km/h
South Railway Ave.: 103rd St. - 104th St.	n/c	n/a	50 km/h
South Railway Ave.: Hwy #4 South - 99th St.	2260	56 km/h	50 km/h
South Railway Ave.: Battleford Rd - 5th Ave.	1270	56 km/h	50 km/h
Territorial Dr.: Hwy 16 East - Frontier Way	7725	60 km/h	60 km/h
Territorial Dr.: North of Walmart - 8th Ave.	11385	69 km/h	60 km/h
Territorial Dr.: 8th Ave. - 11th Ave.	11828	78 km/h	80 km/h
Territorial Dr.: McMillan Rd. - Train Bridge	n/c	n/a	80 km/h
Territorial Dr.: 13th Ave. - 15th Ave.	11337	77 km/h	80 km/h
Territorial Dr.: 15th Ave. - Wearing Rd	9870	80 km/h	80 km/h
Territorial Dr.: Wearing Rd - Douglas Ave.	9846	82 km/h	80 km/h
Territorial Dr.: Millar Rd - Scott Dr.	7711	78 km/h	80 km/h
Territorial Dr.: Scott Dr. - Clements Dr.	8106	71 km/h	80 km/h
Territorial Dr.: Clements Dr. - Hwy #4 North/100th St.	4605	57 km/h	50 km/h
Territorial Dr.: Mall Access - 95 St./Killdeer Dr.	9101	64 km/h	50 km/h
Territorial Dr.: 95th St./Killdeer Dr. - 19th Ave.	5213	83 km/h	80 km/h
Territorial Dr.: 19th Ave. - Peyak Trail	5132	78 km/h	80 km/h
Thatcher Ave.: Jersey St. - Aberdeen St.	906	56 km/h	50 km/h
Thomas Ave.: Foley Dr. - Thomas Ave. NE	163	41 km/h	50 km/h
Thomas Ave.: Foley Dr. - Abbott Ave.	233	41 km/h	50 km/h
Yellowsky Dr.: North of Calton Trail	852	33 km/h	50 km/h

Figure 1 is a diagram showing all the 2023 traffic count locations that are listed in Tables 1. The complete City is divided into quarters, which are shown in figures 2-5 on the following pages.

Figure 1: Grid for 2023 Traffic Volume Count Locations

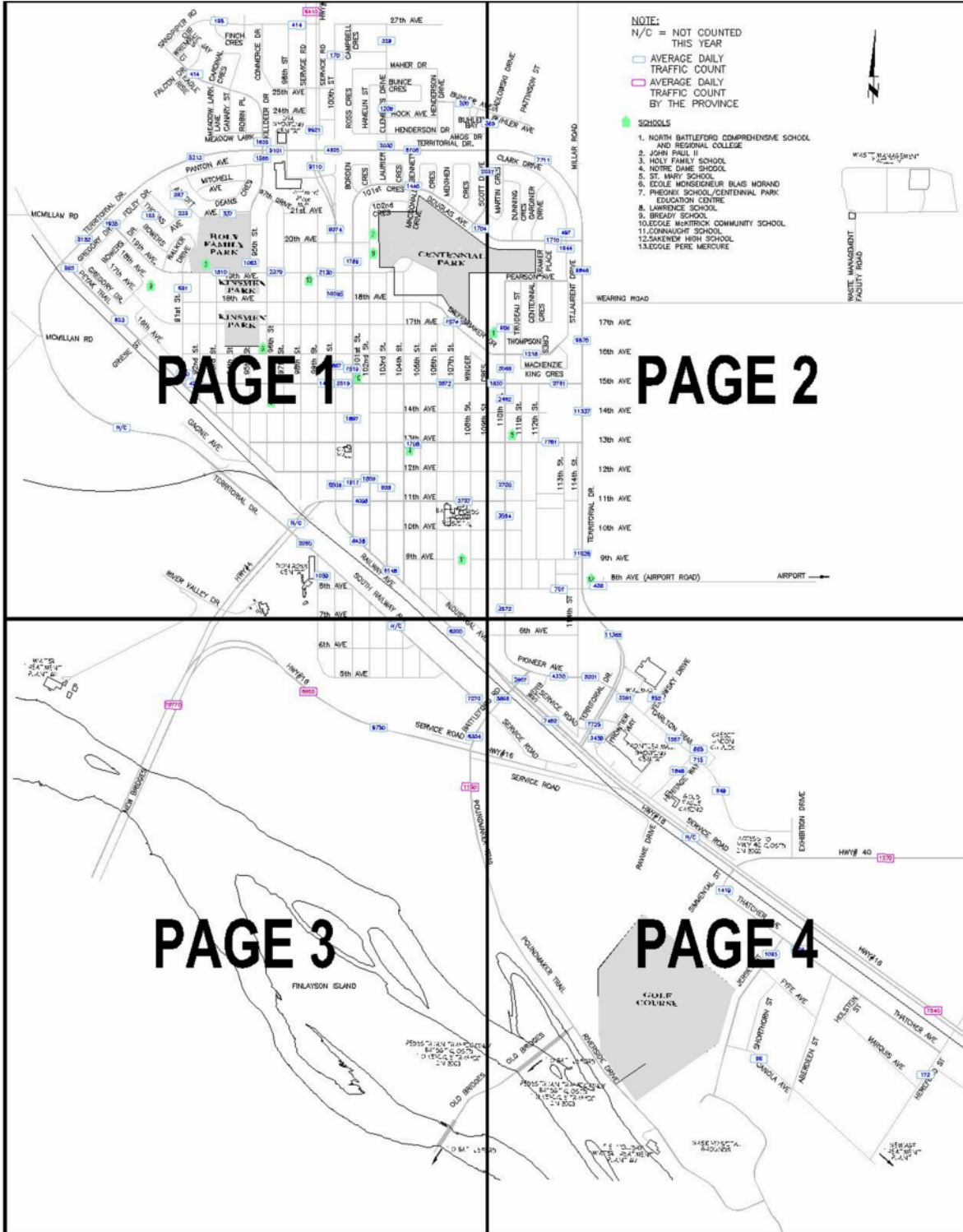

Figure 2: Page 1 of 2023 Traffic Volume Count Locations

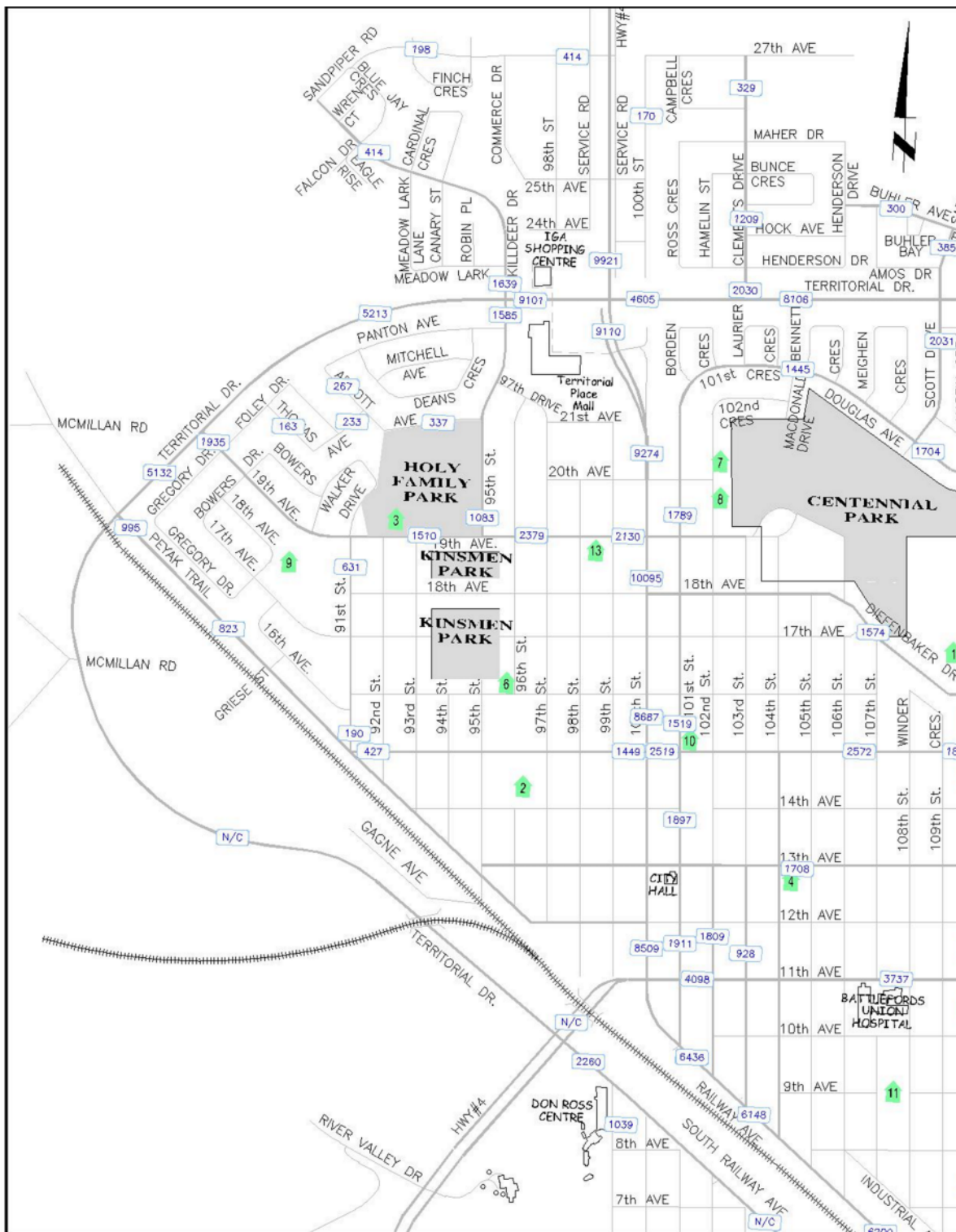

Figure 3: Page 2 of 2023 Traffic Volume Count Locations

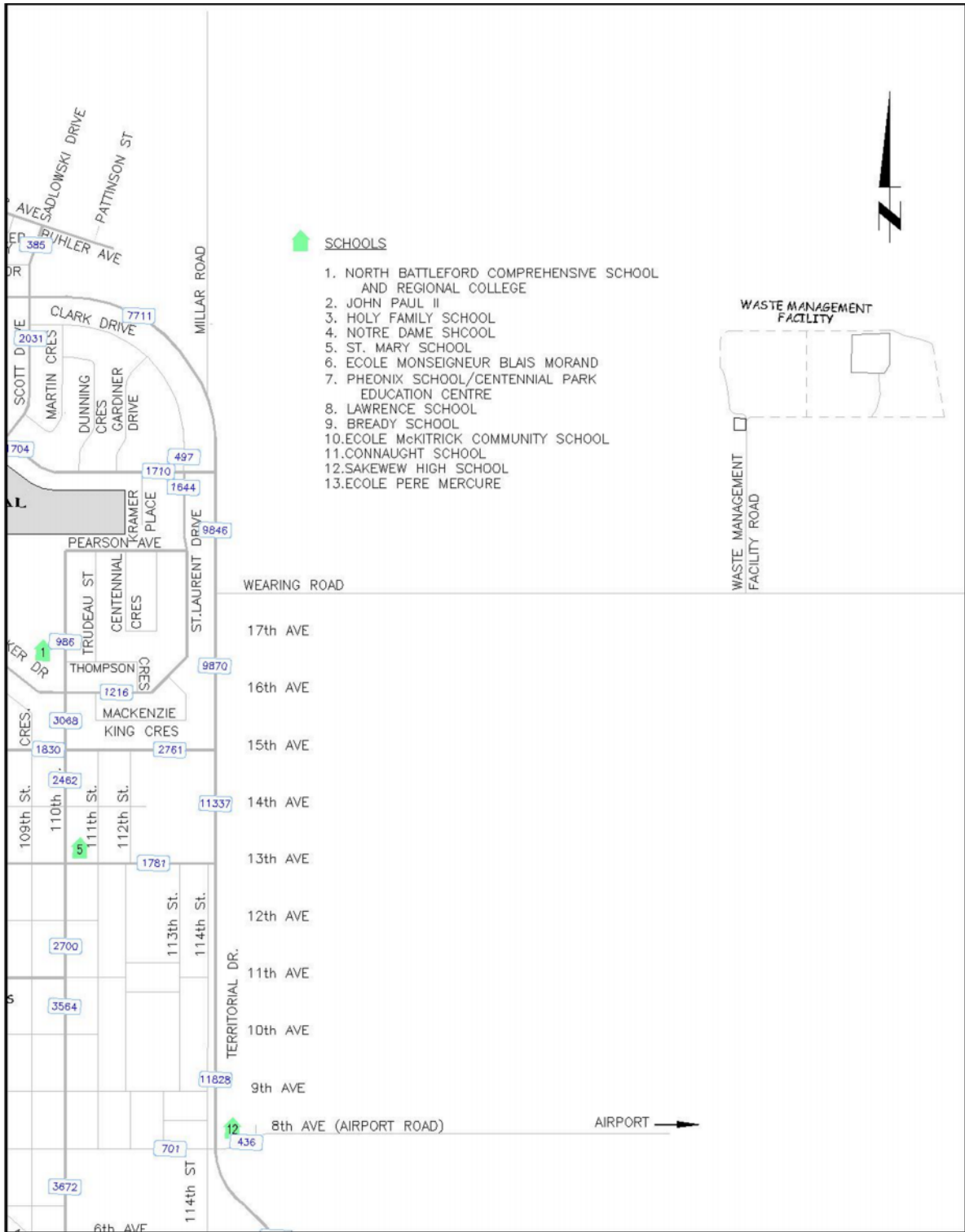

Figure 4: Page 3 of 2023 Traffic Volume Count Locations

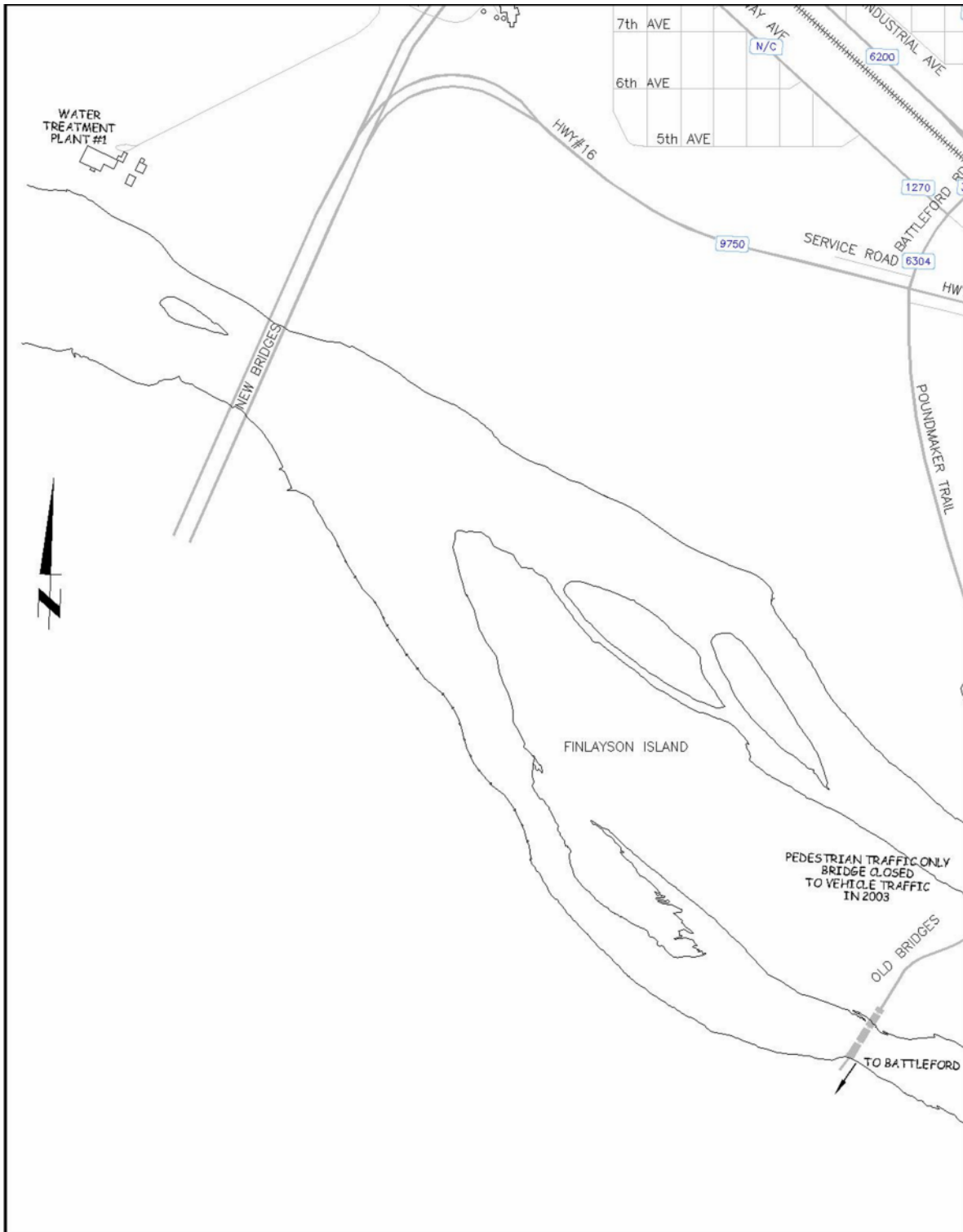

Figure 5: Page 4 of 2023 Traffic Volume Count Locations

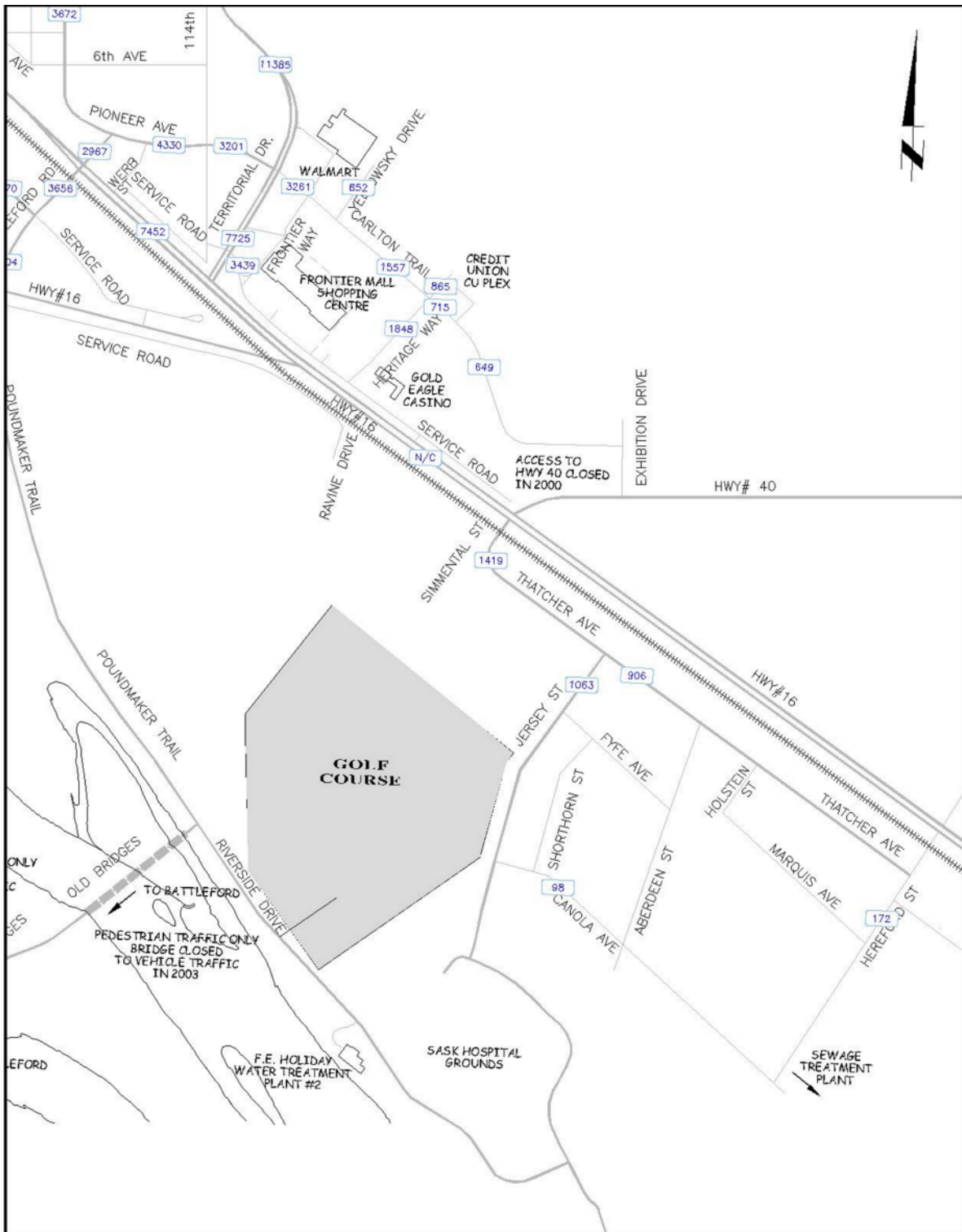

Figure 6: Page 1 of 2023 85 Percentile Speed Locations

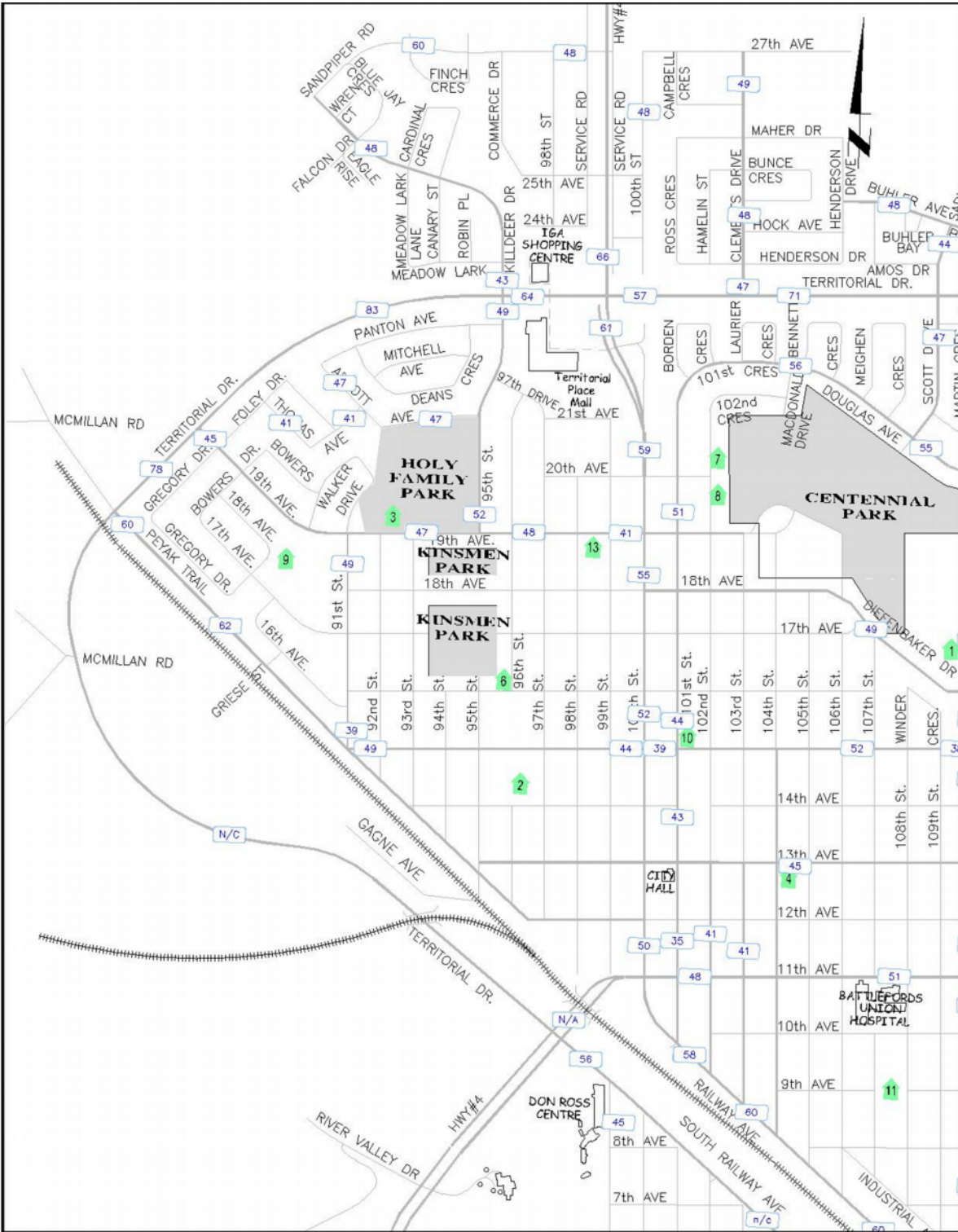

Figure 7: Page 2 of 2023 85 Percentile Speed Locations

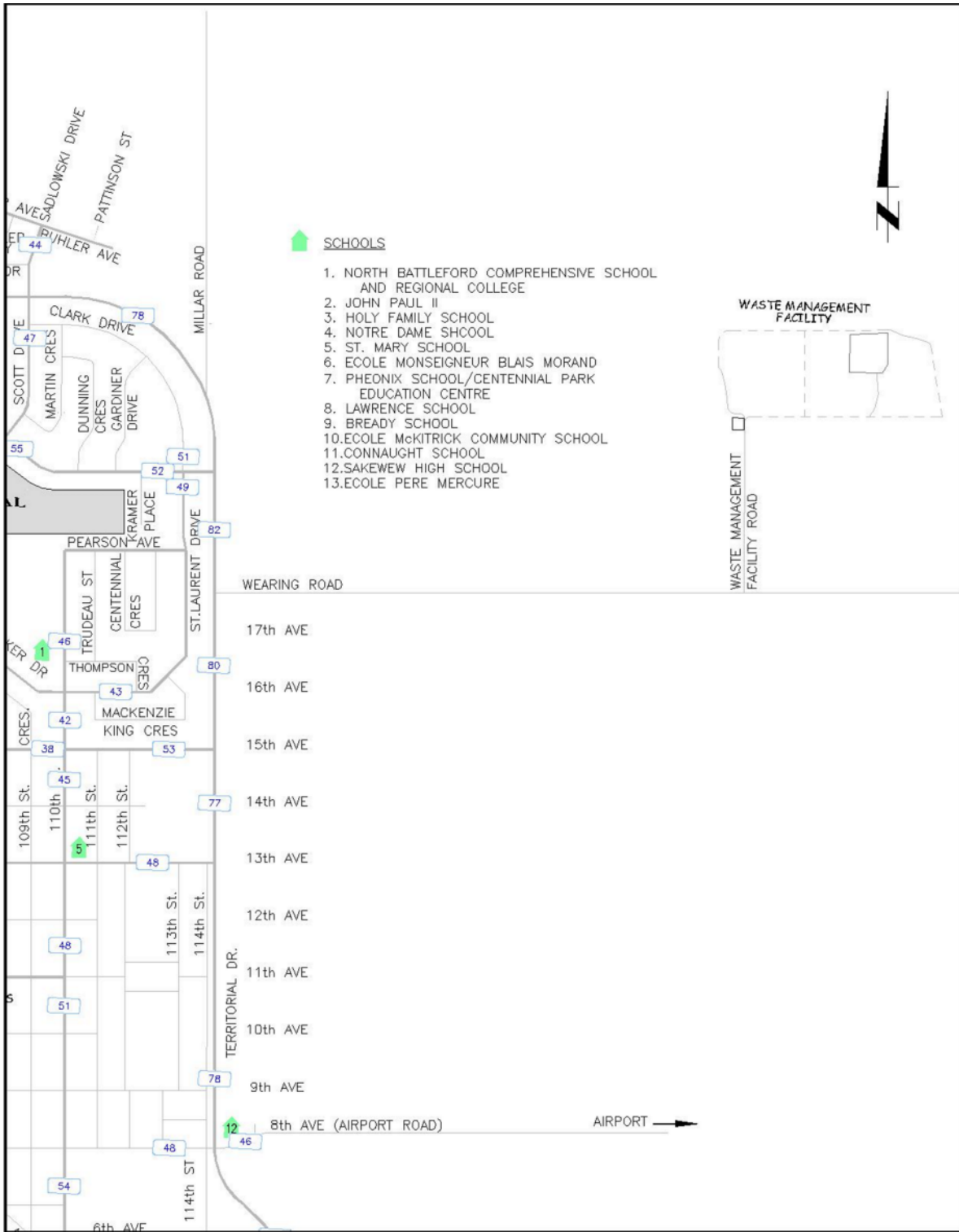

Figure 8: Page 3 of 2023 85 Percentile Speed Locations

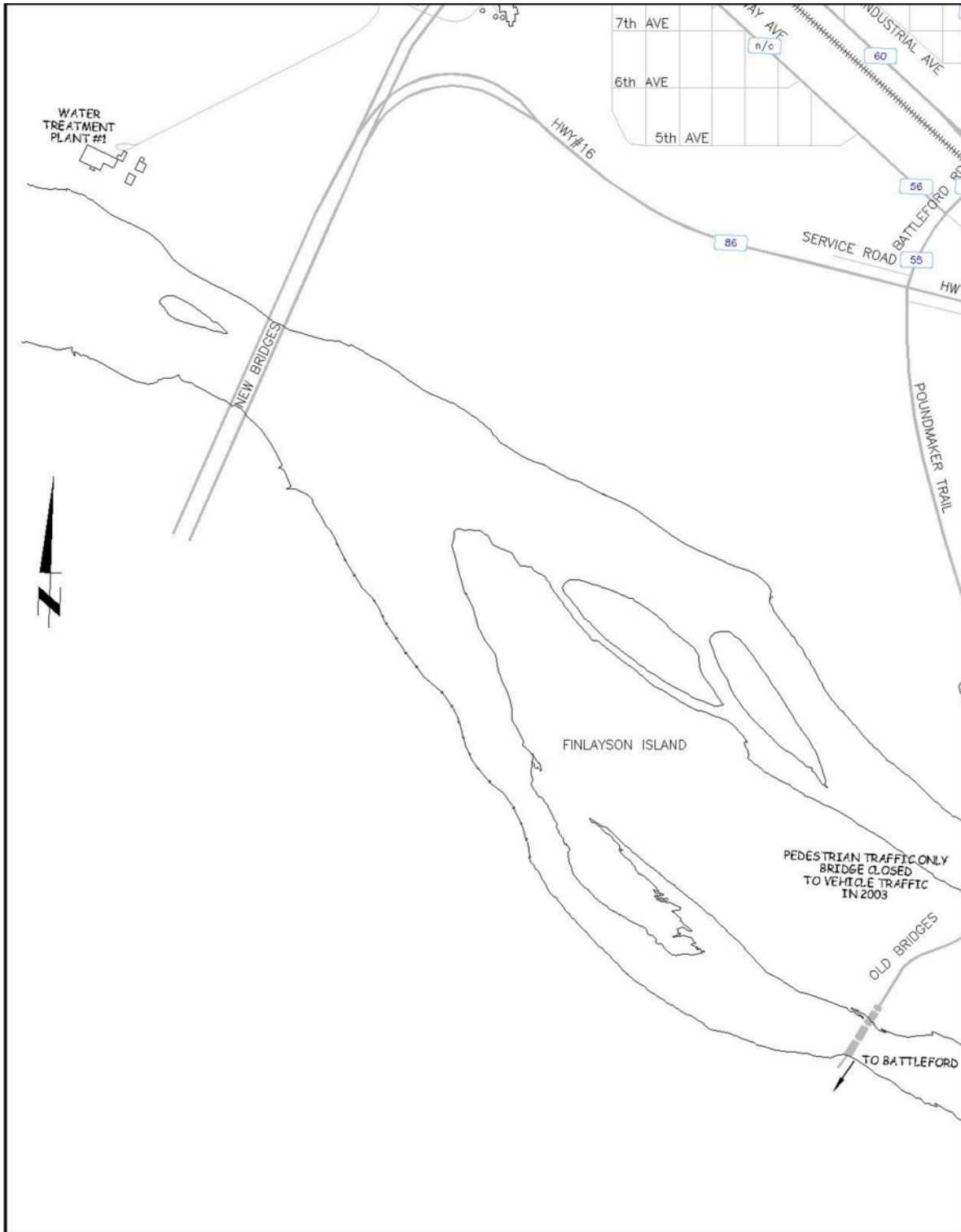

Figure 9: Page 4 of 2023 85 Percentile Speed Locations

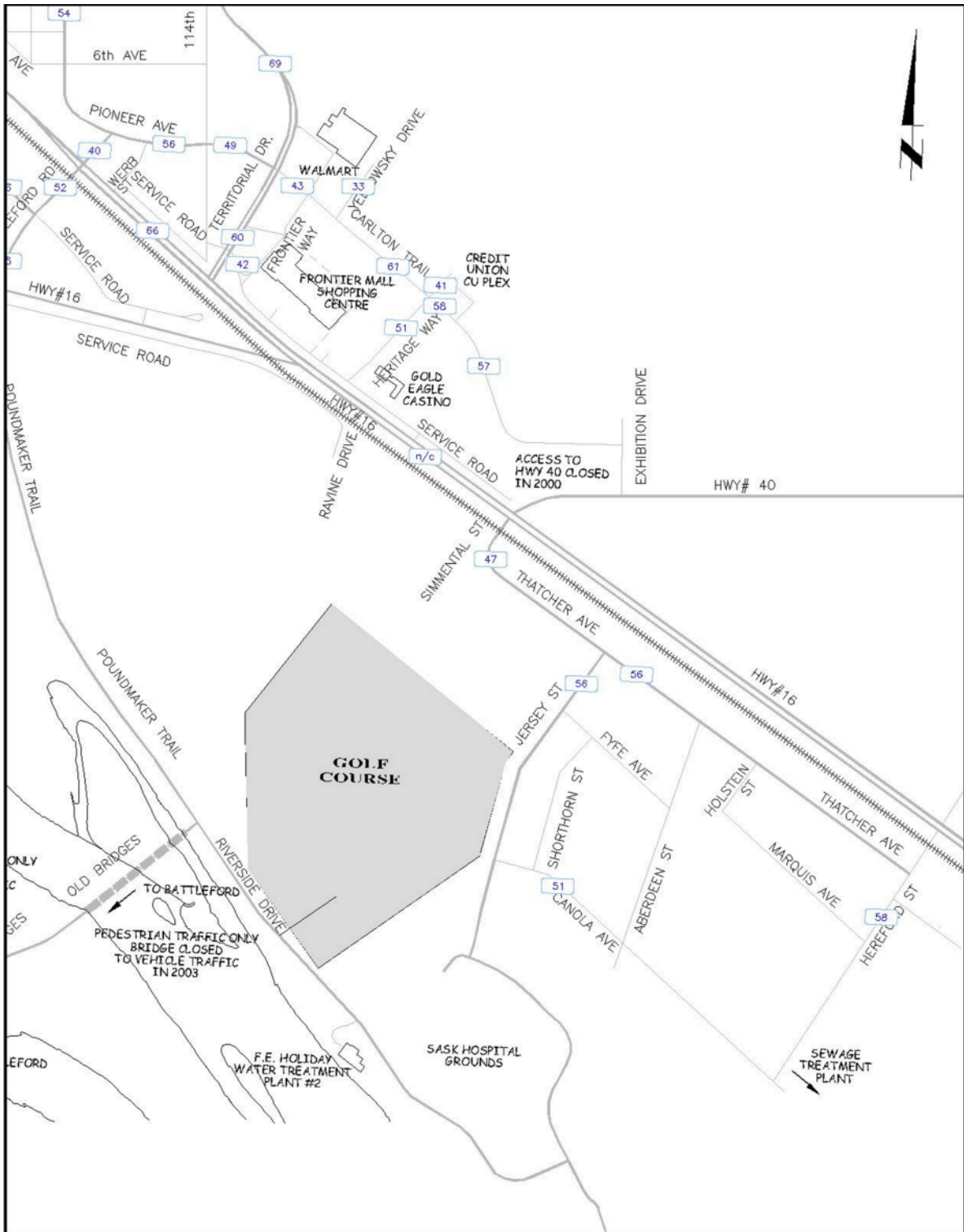

Figure 10: Page 1 of 2023 Speed Limit Locations

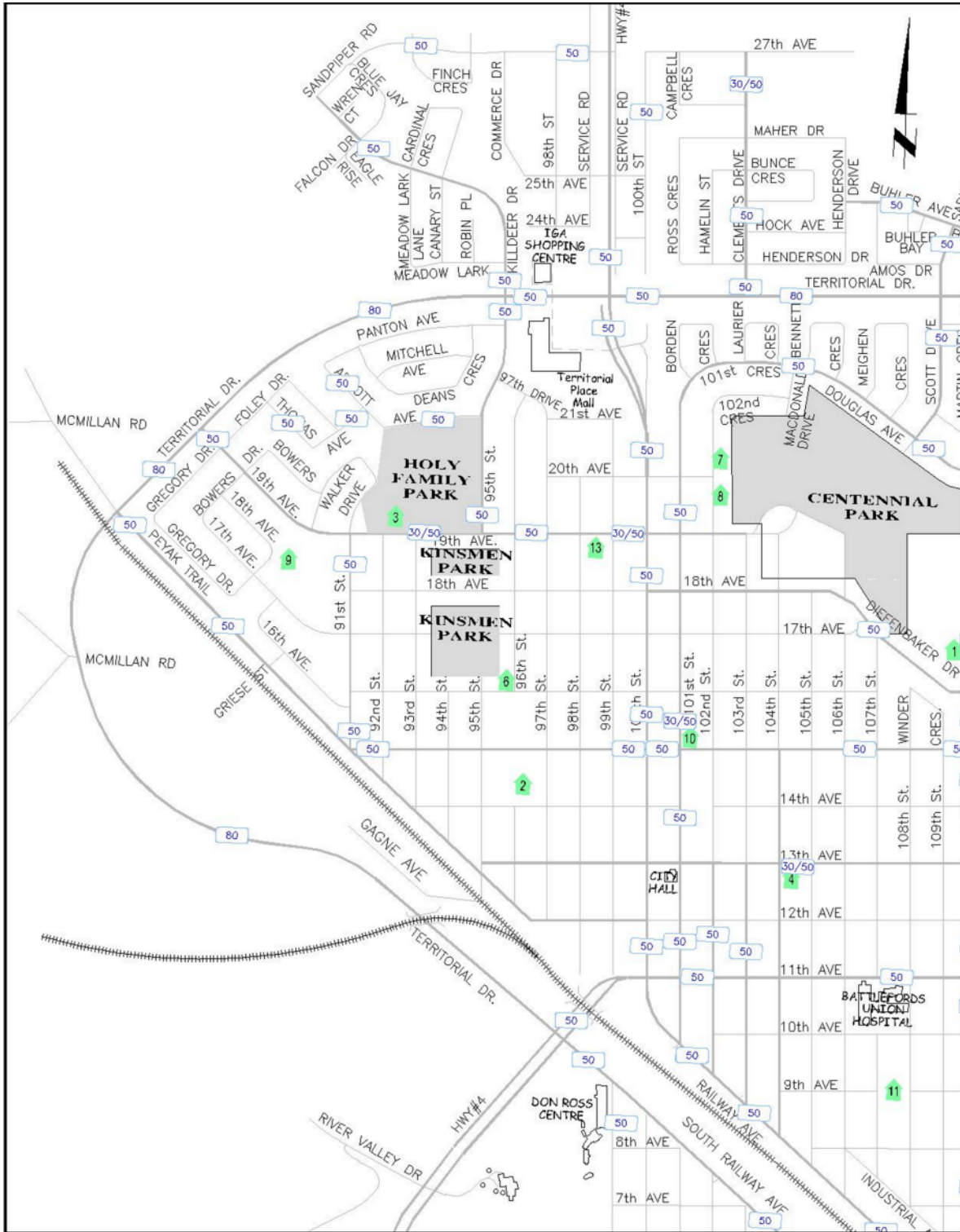

Figure 11: Page 2 of 2023 Speed Limit Locations

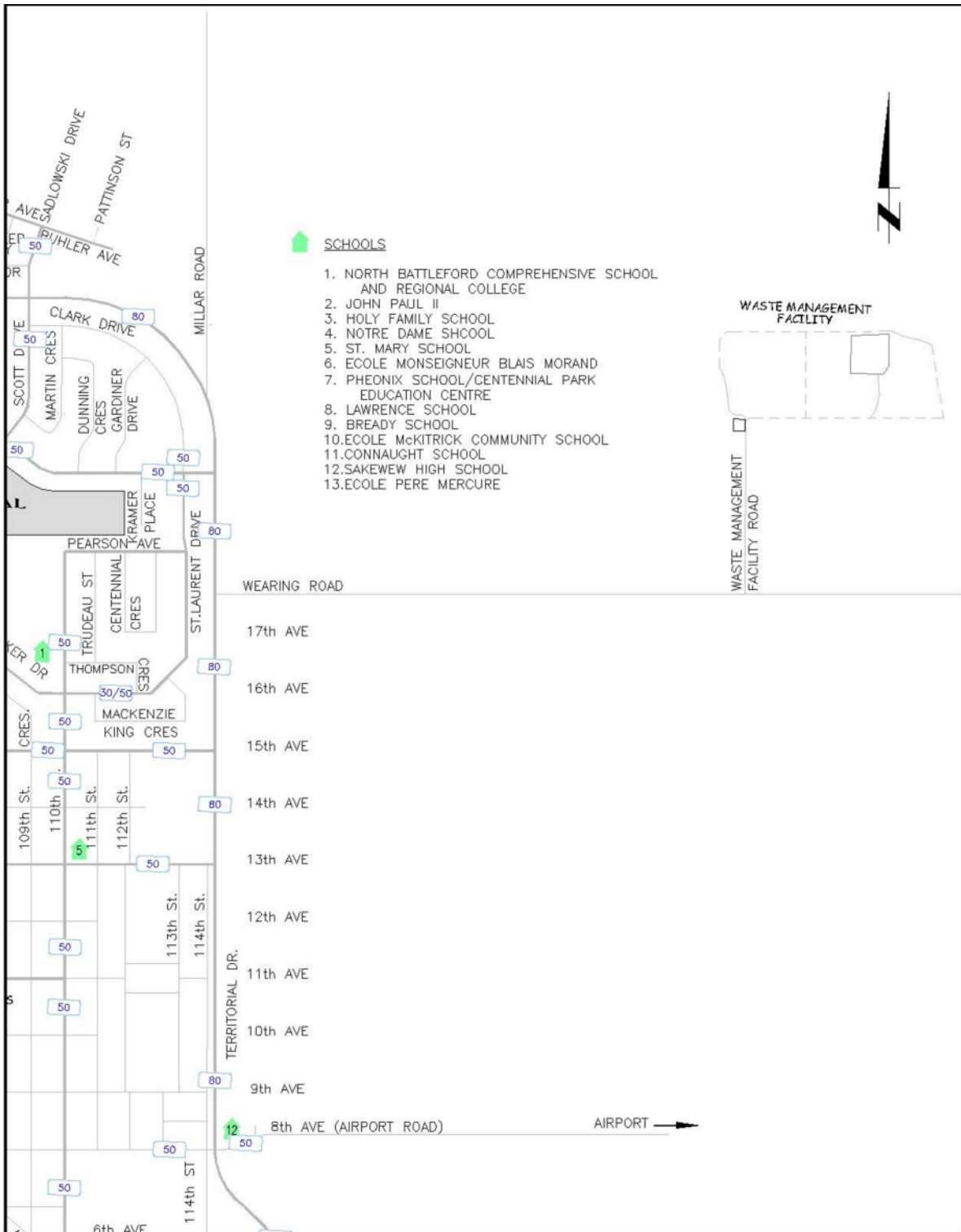

Figure 12: Page 3 of 2023 Speed Limit Locations

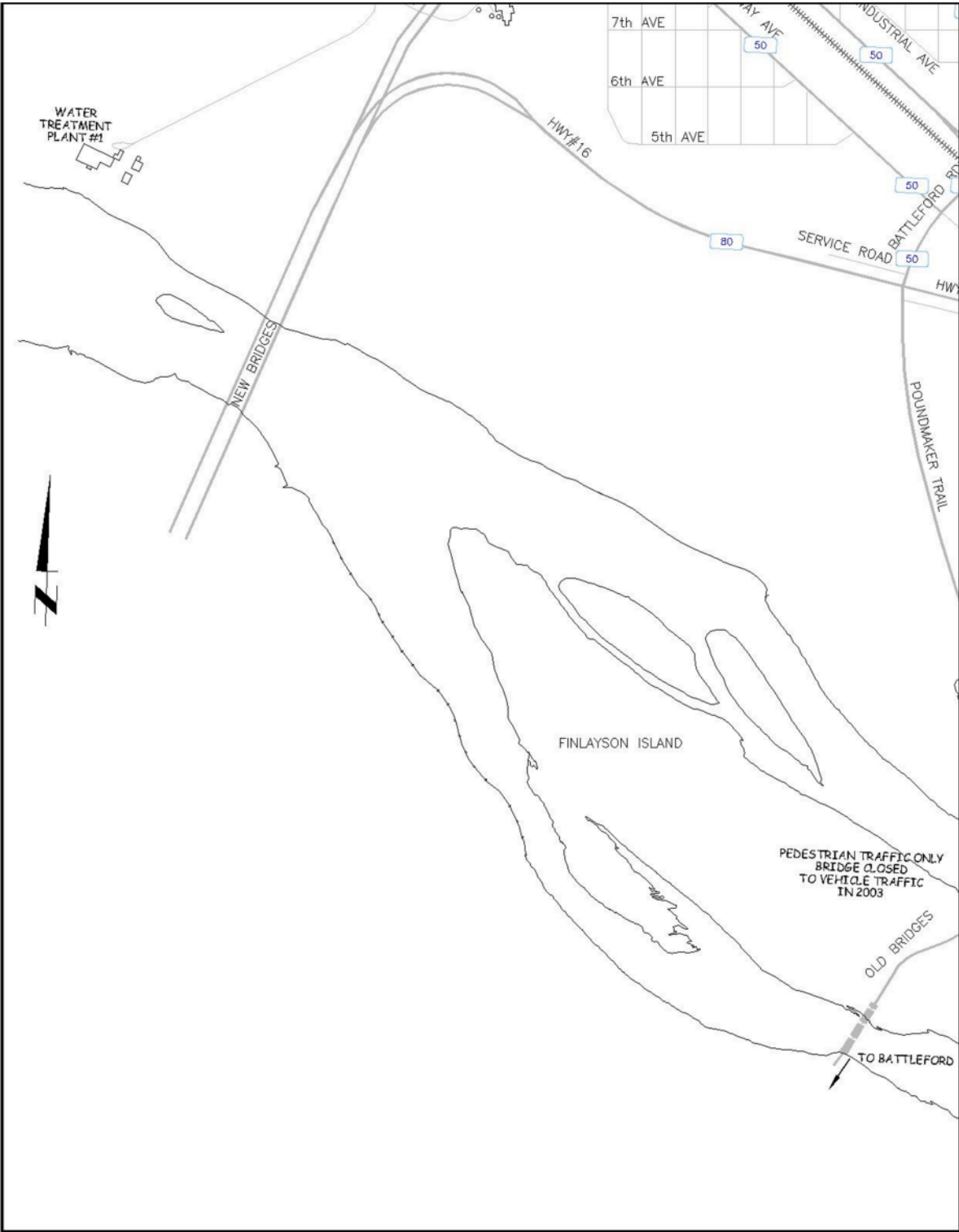
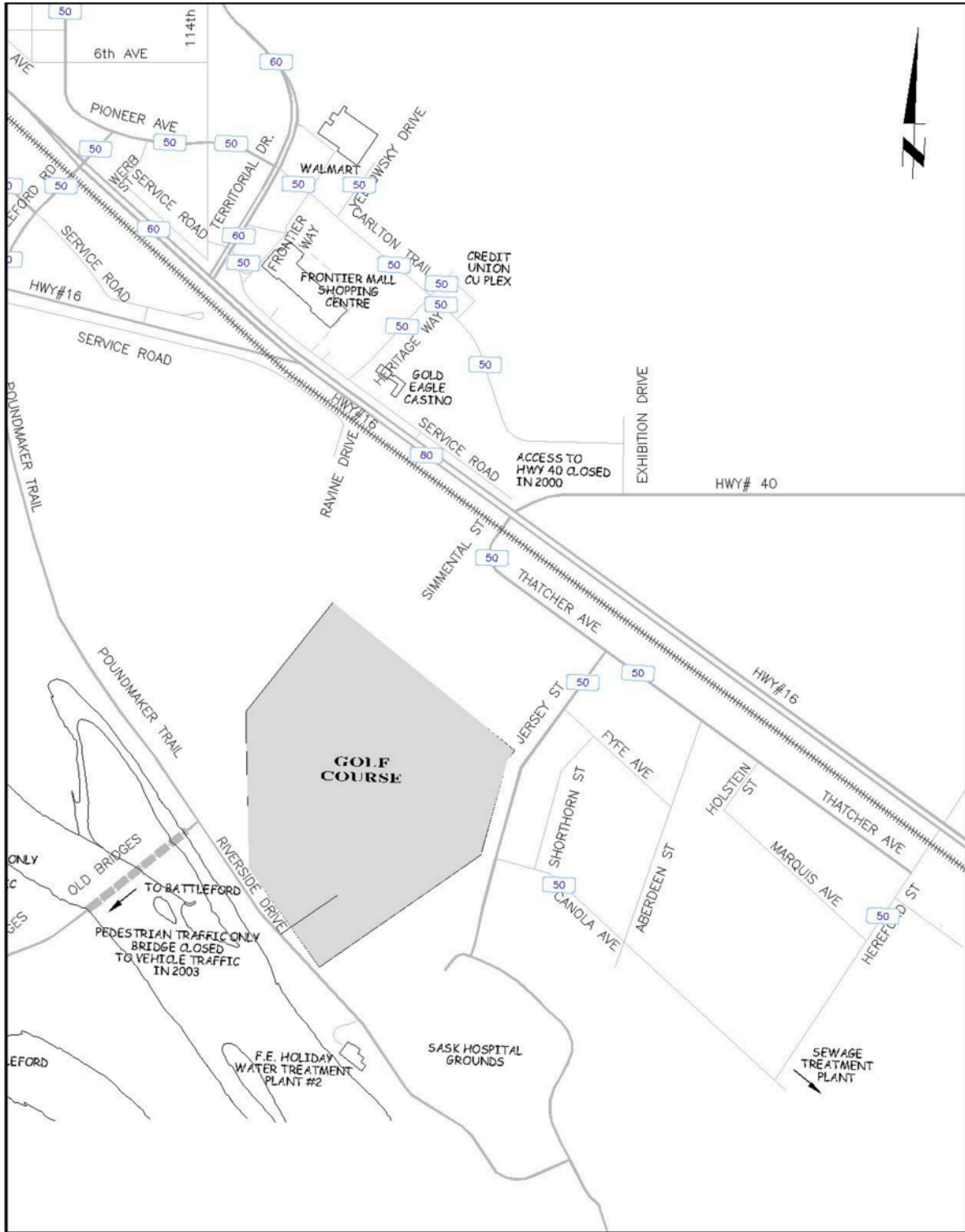

Figure 13: Page 4 of 2023 Speed Limit Locations



CONCLUSION

The traffic volumes recorded throughout 2023 and previous years assist the City, individuals, and various organizations in important decisions related to traffic volumes at different locations throughout the City. This report does not analyze the documented traffic volumes. It shows the traffic volumes at many locations throughout the City as well, it explains the traffic counting procedure used and how traffic counts are calculated to come up with an average daily count for a location. This report can be used as a reference for individuals and various organizations wanting to know traffic volumes at locations throughout the city of North Battleford.